



WHISTLER

Meadow Park

Engagement Summary 2

Prepared by

VDZ+A

September 22, 2023



Table of Contents

P.3 **Engagement Overview**

P.3-4 What We Heard - Feedback Summary

P.5 **Survey Results**

P.5-6 Demographics

P.7 Connection to Meadow Park

P.8 Sufficiency of Fitness Workout Area

P.9-10 Sufficiency of Spray Park Area

P.11-12 Sufficiency of Playground Area

P.13 Sufficiency of Open Lawn

P.14 Sufficiency of Off-Leash Dog Park

P.15 Sufficiency of Youth Area

P.16 Sufficiency of River Front Picnic Area

P.17-18 Sufficiency of Shade and Seating

P.19 Preference between Option 1 and Option 2

P.20-24 Overall Support and Additional Comments

P.25-26 Next Steps

Appendix

What we Heard

Feedback Summary

In June 2024, RMOW engaged with the community during 3 pop-up open house events and an online survey that was available for 2 weeks. These are the main themes formed from conversations with the public and their input on the map/comment board.

4) Did you attend the Meadow Park Pop-Up booths at Whistler Public Library or Meadow Park Sports Centre in June 2023?

Yes: 14.4% (39 Respondents)

No: 81.9% (221 Respondents)

I can't remember: 3.7% (10 Respondents)

1/ Excitement for playground and splash park upgrade

- A number of responses from the engagement were resoundingly positive in regards to the playground and splash park.
- Many community members were excited about the potential for an integrated splash park and playground, with many families providing more ideas ranging from more water slides to shade structures to allow play in all four seasons .

2/ A park for the community, not a destination park

- Many Whistler residents expressed that this park be designed with the local community in mind, working to provide places for neighbours to connect and come together for gatherings and;
- Concerns were raised that this park risks is becoming a destination park. The park must reach a fine balance of upgraded amenities and character without becoming too iconic
- These comments were reflected in survey responses despite only 14% of survey respondents attending pop-up booths (see page 20);



3/ Keep the baseball fields

There were numerous queries about what would be happening to the baseball diamonds that currently exist at Meadow Park.

Many comments were made that one baseball diamond could be kept, perhaps integrated into other programs such as the open lawn or dog park.

These comments were reflected in survey responses, see page 21.



4/ Protecting the River of Golden Dreams

- Another common theme from the engagement was the concern of providing river front access to Meadow Park users, especially dogs and how this may disturb the sensitive riparian habitat.
- Residents were concerned that providing any river front access is valuable in Whistler and will create a destination and risk attracting too many visitors to the area.

What We Heard :

Survey Results

Demographics

| | |
|---|---|
|  <p>Age</p> <p>42% 35 to 44</p> | <ul style="list-style-type: none">• 21% Ages 45-55• 12.6% Ages 25-35• 12.6% Ages 55-65• 7.4% Ages 65+• 3.7% Ages 7-24 |
|  <p>Primary Residence</p> <p>85% Whistler</p> | <ul style="list-style-type: none">• 13% Sea to Sky• 1% Lower Mainland• 1% No Answer |
|  <p>Survey 1</p> <p>49% Completed</p> | <ul style="list-style-type: none">• 39.4% did not complete• 11.2% Can't remember |

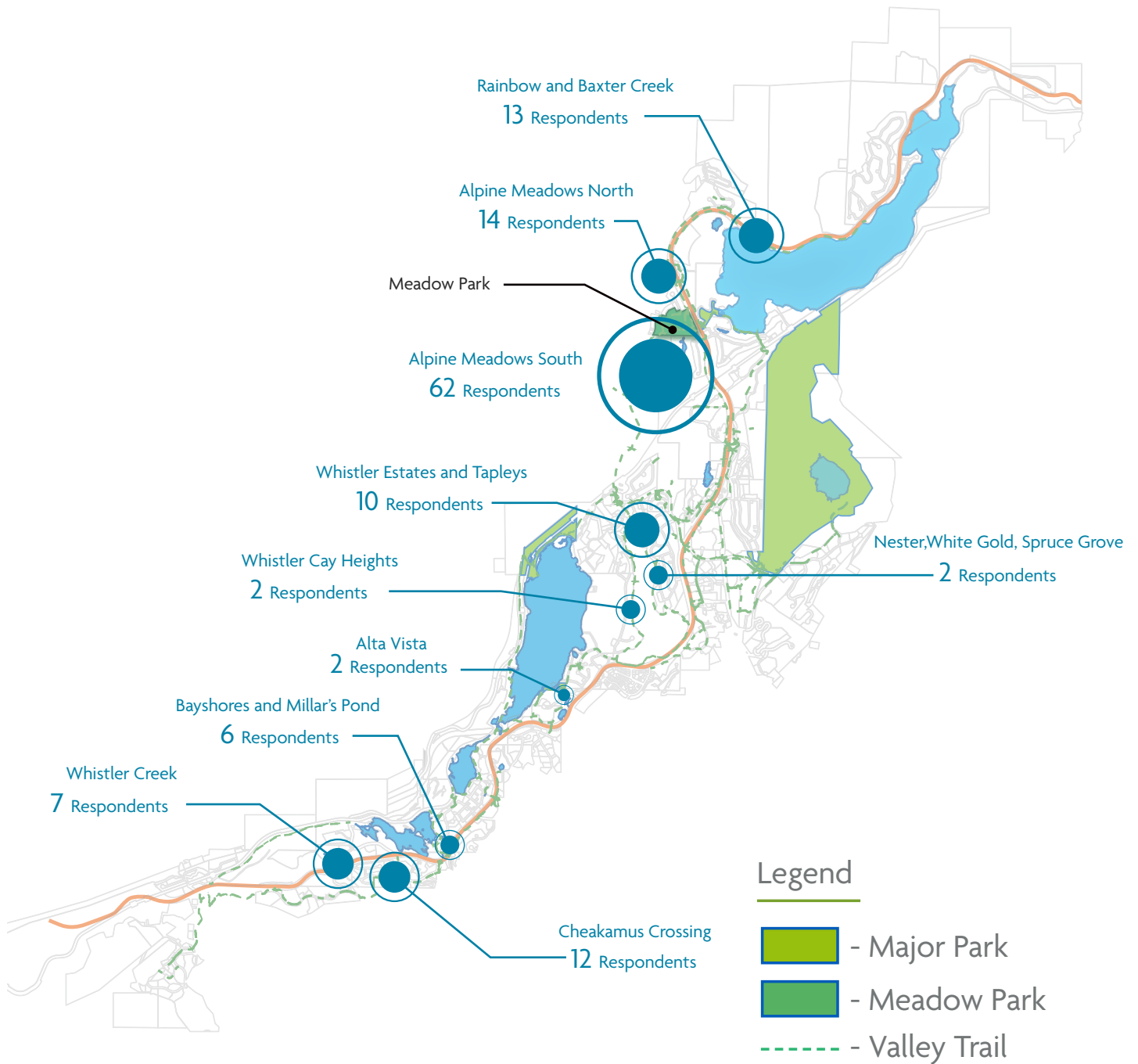

Map of Respondents by Area

- The results of the survey have revealed a blend of respondents from different regions in Whistler, with a notable concentration residing near Meadow Park. The park's local interest is further enhanced by the diverse range of participants, as supported by the data we have collected.
- Please note that not all 271 participants in the survey provided valid addresses or chose to include their address at all.

What is your connection to Meadow Park? (Select all that apply)

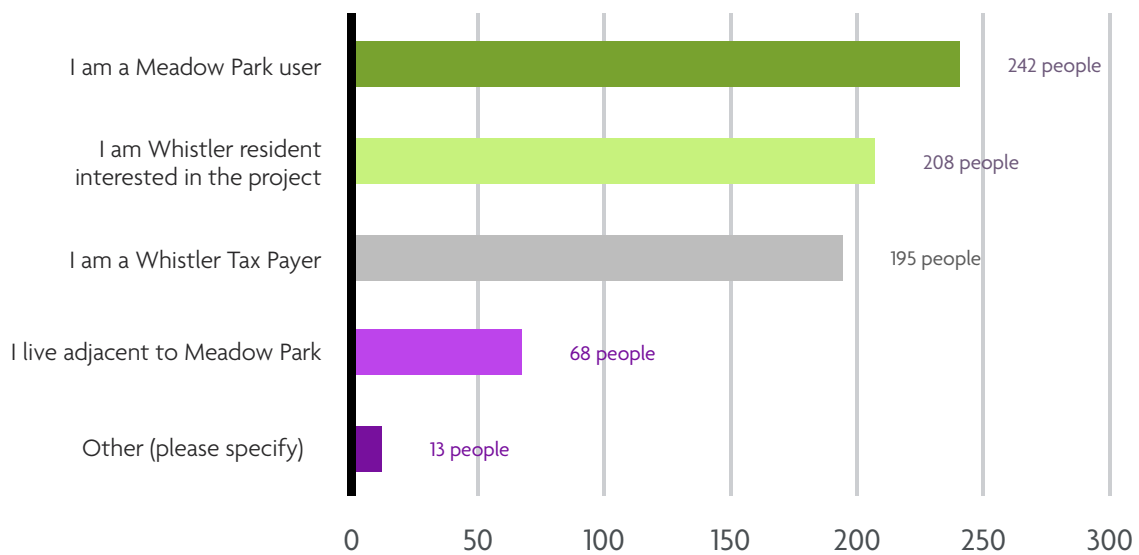

Key Takeaways

- Only one person answered that they do not have a connection to Meadow Park.

Please indicate to what extent you agree with the following:

The area dedicated to the walking loop and outdoor fitness equipment area is sufficient

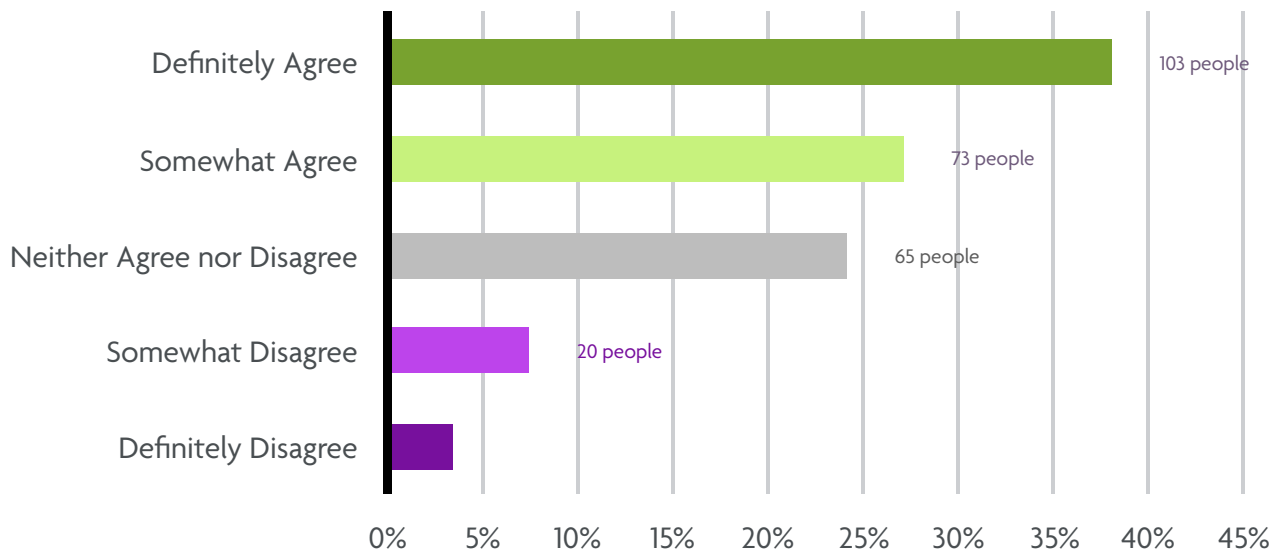

“ More outdoor fitness structures like chin up bars and places to hang a TRX and soft rubber matting for push ups and sit ups.”

Survey Respondent

“ Outdoor gym equipment (machines) are a waste of time. Perhaps more modern styles of outdoor workout like callisthenics, bars, rings and ropes etc. Perhaps bouldering...”

Survey Respondent

Key Takeaways

- No comments were mentioned by respondents on the walking loop.
- Overall 5 respondents were excited about the outdoor fitness area with many pointing to having more customizable outdoor fitness elements with pull-up bars for a flexibility of exercises such as TRX and Cross fit.

Please indicate to what extent you agree with the following:

The area dedicated to the Spray Park is sufficient

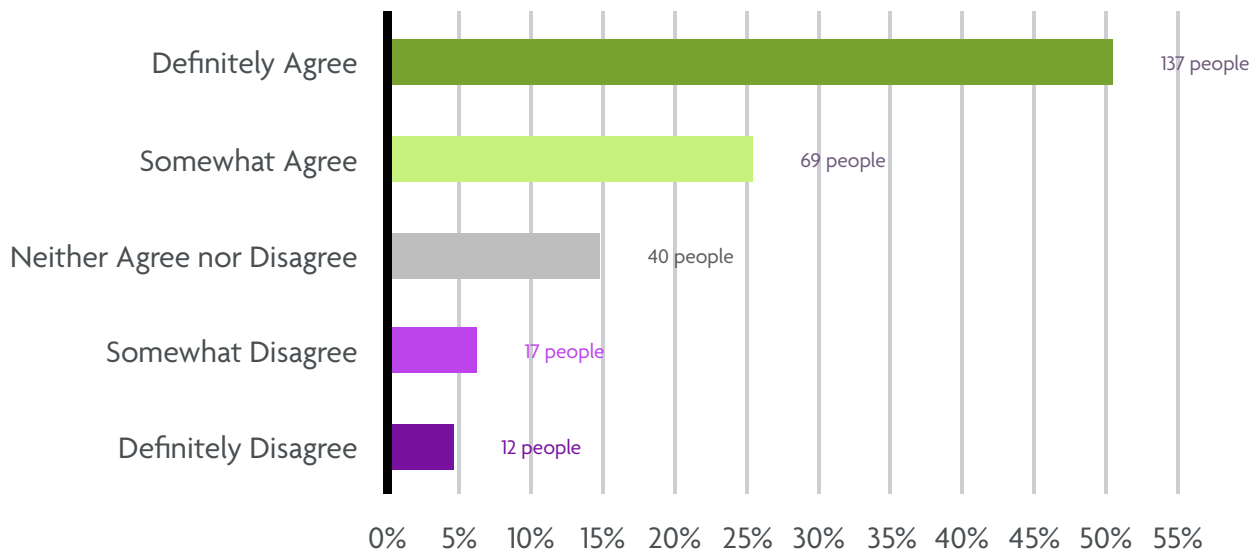

Overall, how supportive are you of the draft concept for the Spray Park?

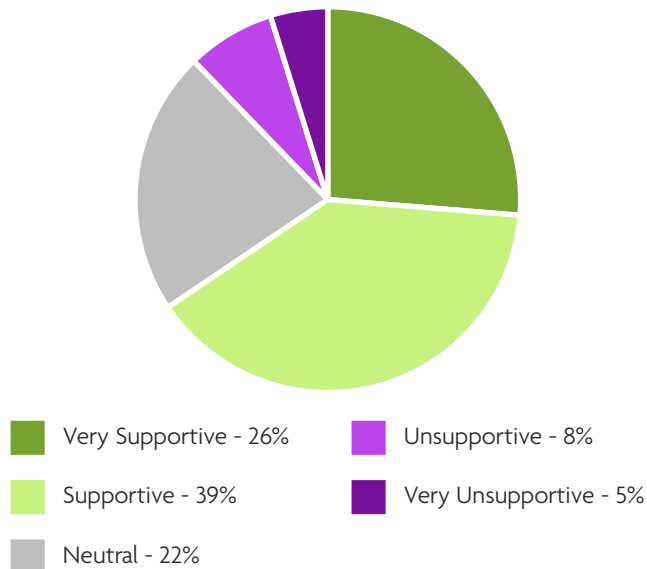

Please indicate to what extent you agree with the following:

I will use the proposed play features in the Spray Park

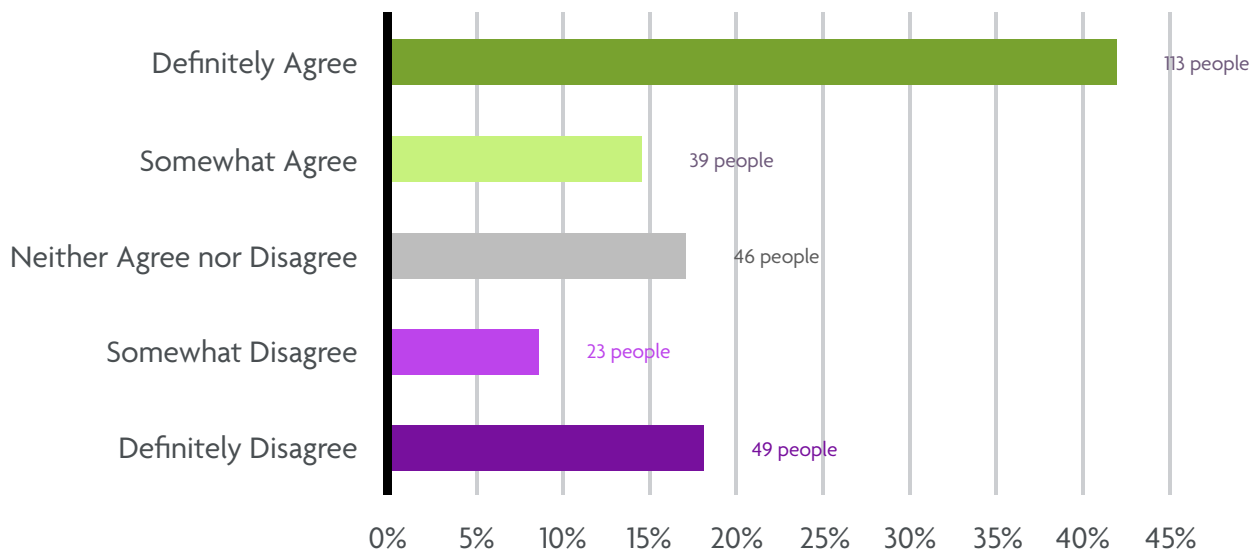

Key Takeaways

- Of those who will use the spray park (answers = Definitely agree; Somewhat agree), 77% of them agree that the spray park area is sufficient.
- Concerns raised about potential safety of trails passing through spray park and playground area as well as ensuring good sight lines.

“

We would love MORE SLIDES in the water park! The slides are the best and biggest feature of the spray park.

”
Survey Respondent

“

Keep site lines open in spray park and playground. Currently the big appeal of the spray park/playground, is that parents can supervise their children from one area...

”
Survey Respondent

Please indicate to what extent you agree with the following:

The area dedicated to the Playground is sufficient

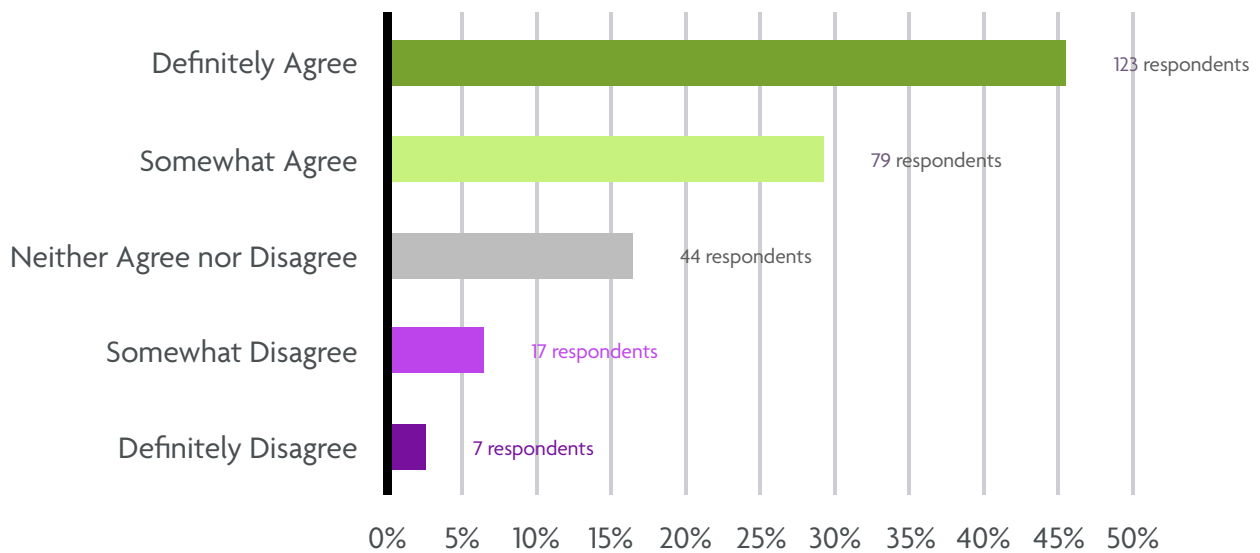

Overall, how supportive are you of the draft concept for the Playground?

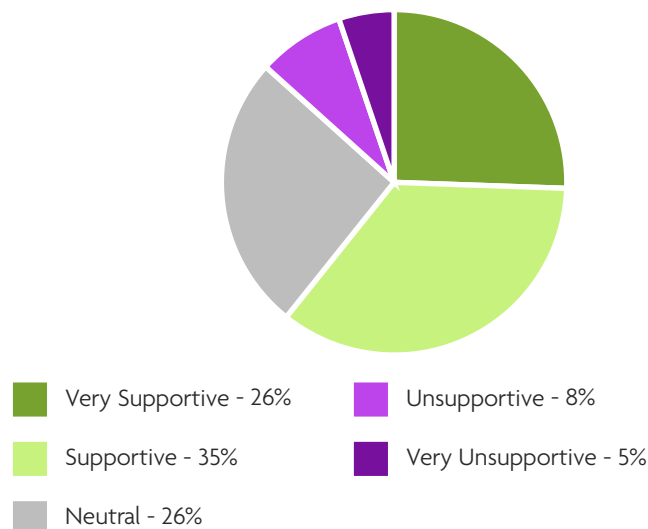

Please indicate to what extent you agree with the following:

I will use the proposed play features in the Playground

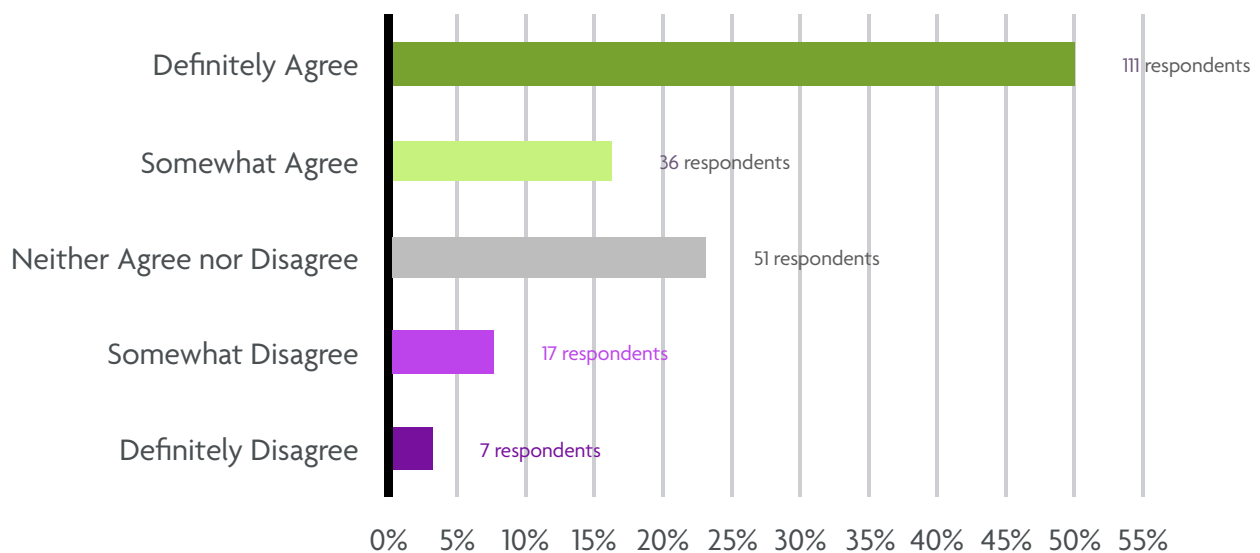

Key Takeaways

- Of those who will use the spray park (answers = Definitely agree; Somewhat agree), 82% of them agree that the spray park area is sufficient.
- Four comments mention the importance of providing accessible playground features such as swings for wheelchair users.

“ I would much rather see sand, wood mulch, grass, and cement as the surfaces used for the play areas and splash pads...”

”
Survey Respondent

“ Would prefer to see slide as a structure as opposed to regrading the park to create an artificial hill like already exists in Tapley’s.”

”
Survey Respondent

Please indicate to what extent you agree with the following:

The area dedicated to the Open Lawn is sufficient for a passive space

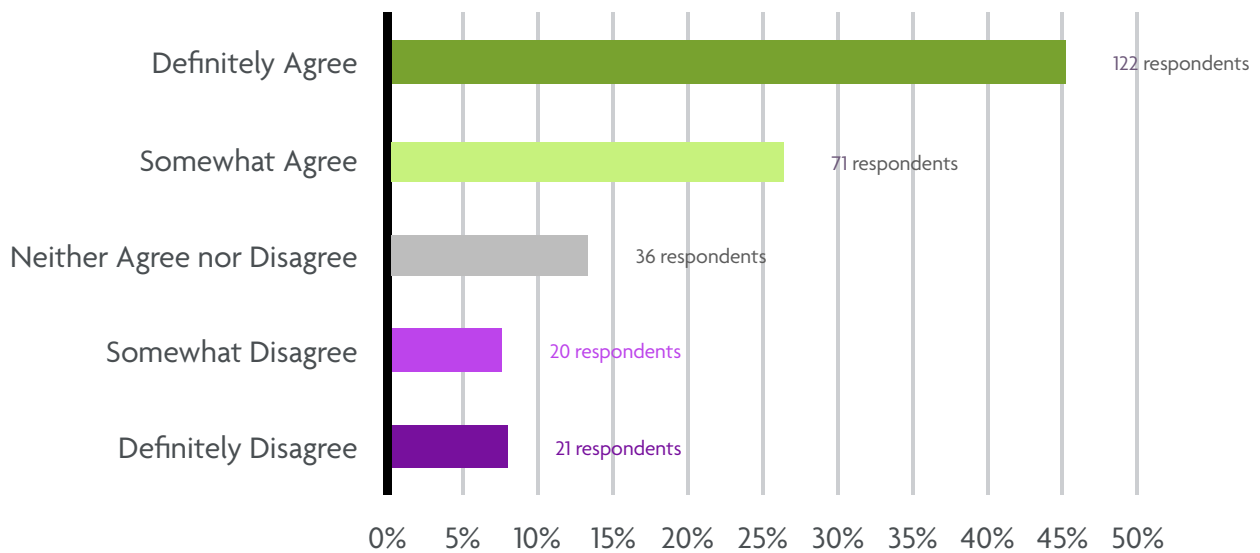

Key Takeaways

- Comments point to preserving open lawn space for random programming (3 respondents) and paraglider landing (5 respondents).
- Four respondents noted that the open lawn area is too big and could integrate other programs such as a pump track.

“

More deciduous trees for shade in the open lawn area. Those are often the most coveted spots at rainbow Park.

Survey Respondent

”

“

The open lawn area is crucial...the space is flexible for use which means a wide range of uses depending on the seasonality. Can pick up a Frisbee and toss it around or have a family event or have paragliding landing

Survey Respondent

”

Please indicate to what extent you agree with the following:

The area dedicated to the Off-leash Dog Park is sufficient

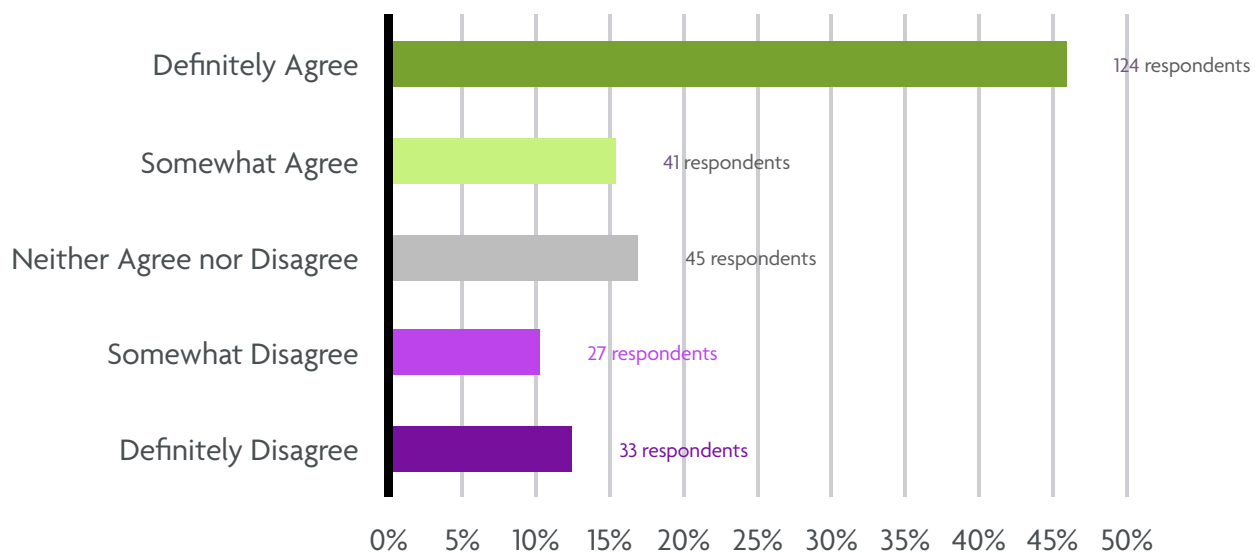
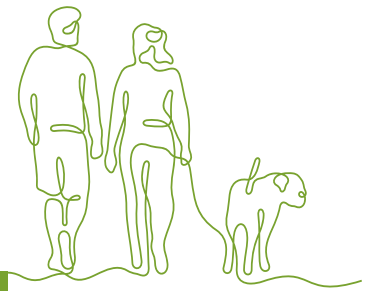

Key Takeaways

- Dog owners have appeared to be very happy with amount of space whereas many other users are not happy and that it is much too large.
- About 14 people noted that the dog area is too large and should be used for other activities.
- 3 dog owners noted that they wanted access to the river for their dogs.

“

Open up the view to the dog park area and connect it to the park, kids love to watch dog play and its nice to see who is in the dog park, see if your dog will have good friend or not.

”
Survey Respondent

“

Would like to see more picnic tables in the dog area so you can relax while the dogs are playing.

”
Survey Respondent

Please indicate to what extent you agree with the following:

The area dedicated to the Youth Area is sufficient

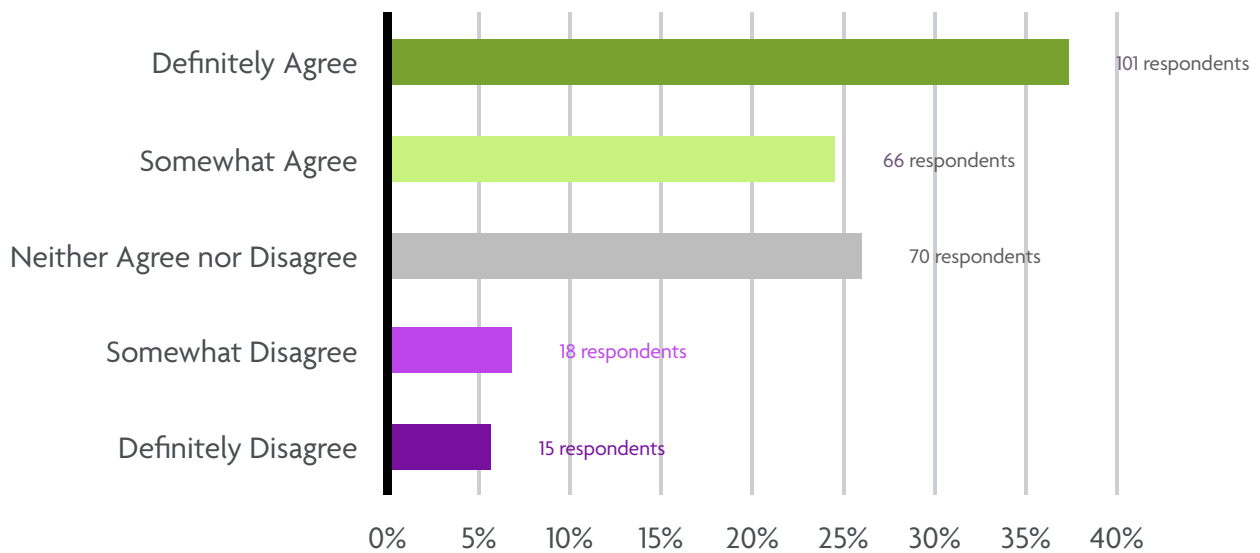

Key Takeaways

- Of the 11 respondents under 24, only 1 person disagreed that the Youth Area was not sufficient.
- Most respondents agreed that the youth area was important and that noise mitigation was critical for its success.
- Other respondents (3) noted that there should be expansion of programs for Youth Area from parkour to other types of program such as skate park, climbing, and pump tracks.

Please indicate to what extent you agree with the following:

The area dedicated to the River front Picnic Area is sufficient

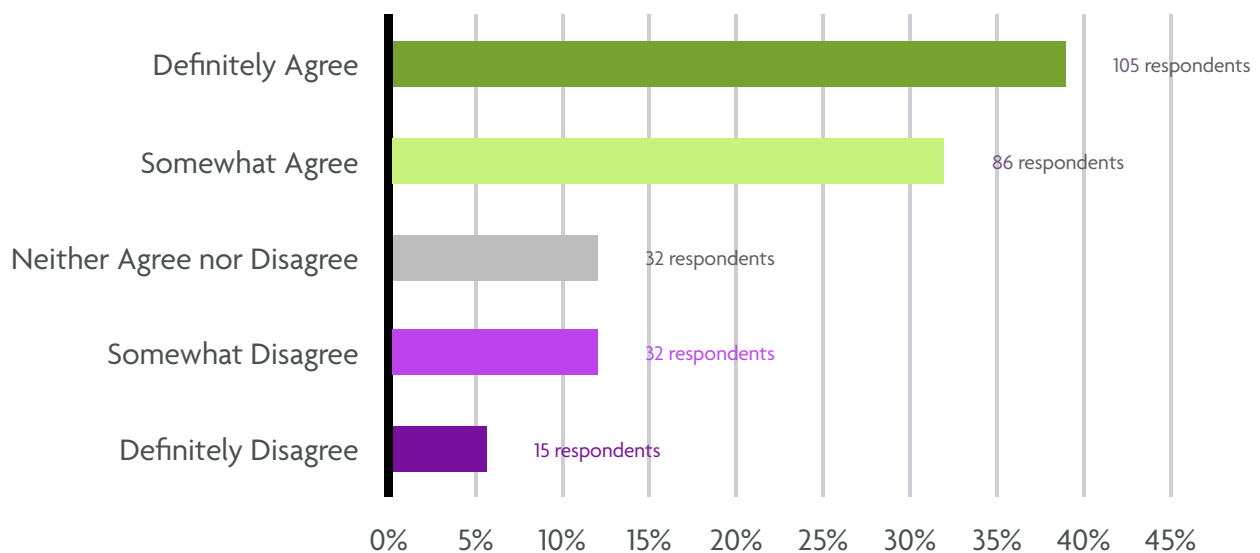

Key Takeaways

- 5 respondents noted that more picnic tables should be installed with some accessible seating.
- Some concerns were noted in bringing any access at all to the riverfront area with the sensitive ecosystem, whereas others wanted to have more access to the riverfront for their dogs.
- If a picnic area is provided next to the riverfront, it may encourage swimming which has strengths and weaknesses depending on which survey respondent was asked.

Is there sufficient seating in the draft Meadow Park Master Plan?

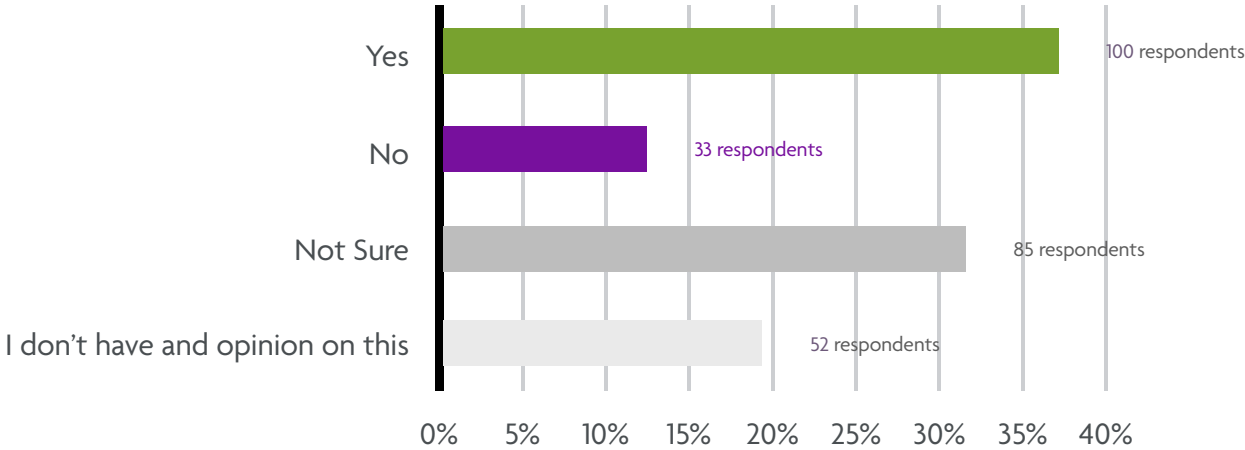

If you answered 'no', please tell us where you'd like to see increased seating

- Many comments supported placing seating next to the water park and playground areas as ideal spaces for supervising children. It is also important to have tables near these playground and spray zones for parents and children to eat or do certain types of activities.
- A few have noted the lack of picnic tables in the picnic area and that there need to be more. Picnic tables and seating were also noted to be missing near the water .

“ There should be increased seating by the water play and playgrounds in sun and shade for parents to supervise their kids. ”
Survey Respondent

“ There doesn't appear to be any picnic tables in the picnic area. Especially for people with disabilities for whom sitting on the ground is not an option, picnic tables and benches are an important feature. ”
Survey Respondent

Is there sufficient shade proposed in the draft Meadow Park Master Plan?

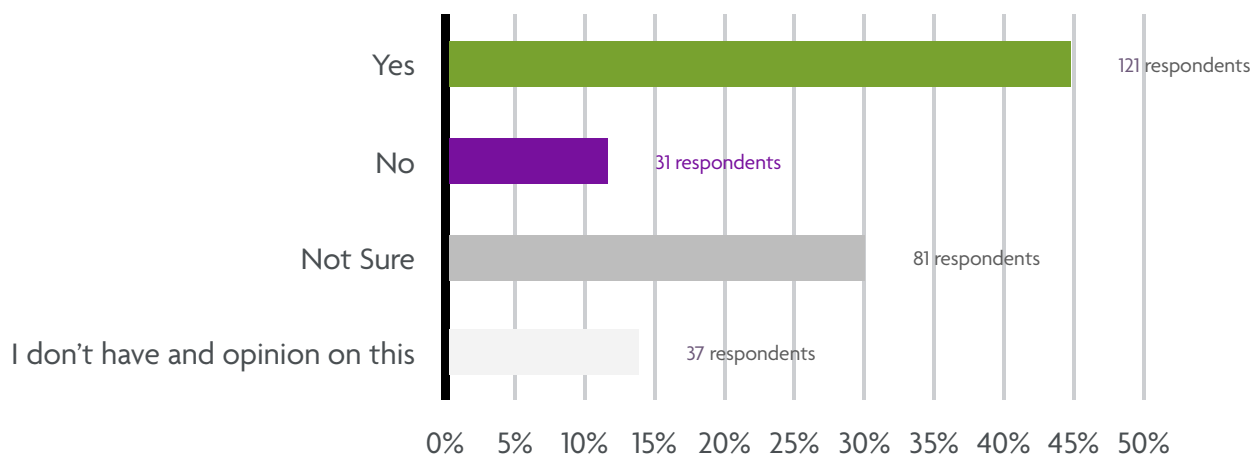

If you answered 'no', please tell us where you'd like to see increased seating

- There are a few notable mentions of setting up shade sails above the playgrounds as most play structures in Whistler can get quite hot and cannot be used in the summer. Covered play areas are also noted to be important during the rainy months of the year.
- There are conflicting opinions about whether shade should be done at the periphery or at the center of the park. Some feel that having pockets of shade are important spanned throughout the open lawn whereas others would like them kept to the periphery for a variety of reasons - sunbathing and paragliding.

“ More is better. Make sure there are shade areas through the play areas and open space, not just on the periphery. ”

Survey Respondent

My preference for the Valley Trail alignment adjacent to the Splash Park and Playground is

Option 1: Relocated North/South Valley Trail

- Relocation of path around playground and spray park.
- Change made to enhance safety of park visitors.
- Particularly beneficial for children who frequent these areas.
- Moving path reduce risk of collisions between park visitors and cyclists.

Option 2: Retain Valley Trail as Shared Path

- Promote shared zones.
- Materiality change, signals to cyclists that they should slow down.
- This change has been made to enhance the safety of park visitors.
- Reinforces the idea of the park as a destination and not a corridor.

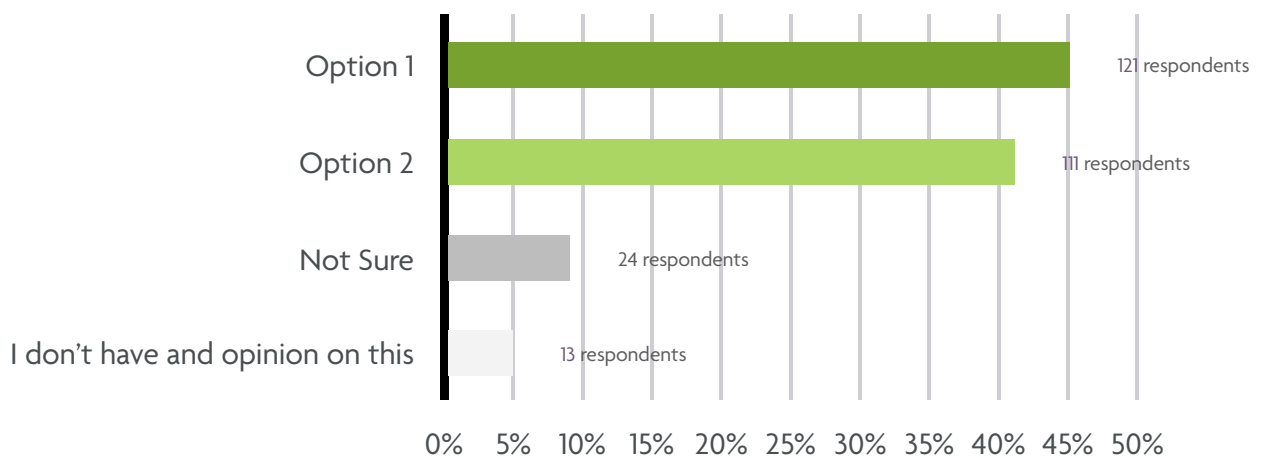
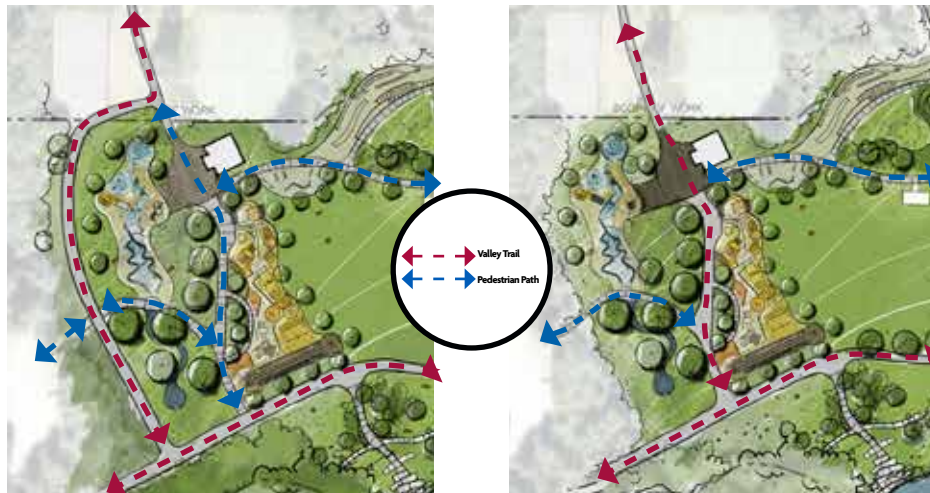

Overall, how supportive are you of the draft Meadow Park Master Plan?

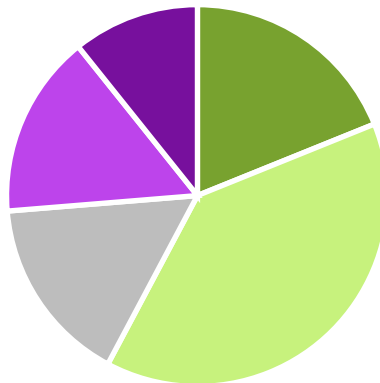

- Very Supportive - 19%
- Supportive - 39%
- Neutral - 16%
- Unsupportive - 16%
- Very Unsupportive - 10%

Ideas for the park

“ Would like to see some kind of tree house structure in the park (similar to the park near Olympic plaza). ”
Survey Respondent

“ Please add a concrete ping pong table. Also retain space for a slackline. ”
Survey Respondent

“ The playground would benefit from a larger rope climbing structure (web) like the ones at Spruce Grove and Myrtle Philip, separate from a main climbing structure. ”
Survey Respondent

Do you have anything else to add regarding the draft Meadow park Master Plan, spray park and playground concepts?

General Concerns

“ I’m concerned that the end goal with this plan is to make another beautiful space and not taking the recreational needs of our community seriously. Sport keeps children busy and provides working opportunities in coaching, officiating etc. It’s necessary for building confidence, and supports mental health. ”

Survey Respondent

“ I would like the residents of Whistler to be considered. 90% of people I meet here are local, we can bump into friends here and make new local connections. ”

Survey Respondent

“ There needs to be more progressive features or alternative lines (‘B’ lines) so kids and beginners can work their way up to the bigger features. ”

Survey Respondent

“ I do not want meadow park to be promoted as a tourist amenity. The whistler families need or will need this infrastructure. Tourism is great but there needs to be limits and management of the industry that leaves room for a community. ”

Survey Respondent

Do you have anything else to add regarding the draft Meadow park Master Plan, spray park and playground concepts?

Baseball Concerns

“

Recommend you guard against well-organized and vocal but minority voices (baseball parents) as they do not represent the entire community and don't "own" the park. Neither do the local residents, this belongs to all of us and we all love it equally. Thanks for reinvesting in our parks, it's certainly not a priority in other places.

Survey Respondent

”

“

Currently both baseball diamonds are in use several nights a week (both organized sports teams and just people playing) why can we not retain at least one?

Survey Respondent

”

“

I am sad that the ball diamonds are being deleted. I feel that the dog owners that use the diamonds for use is fine. I don't want to lose any opportunity for the sport in the community.

Survey Respondent

”

Do you have anything else to add regarding the draft Meadow park Master Plan, spray park and playground concepts?

River Front Access

“

I would like to see more consideration to preserving the sensitive environment of the River of Golden Dreams as it intersects with the park. I feel concerned that increased access for humans and dogs to the water might be detrimental to this river and its natural inhabitants.

”
Survey Respondent

“

I disagree with adding the access point to the river. It's overused by tourists who don't respect the wildlife and this opens it up even more. It's also a very cold river, which presents a danger to those who don't recognize this as a risk.

”
Survey Respondent

“

Retain and reforest Riparian areas along the River of GD. Clear and accessible access to the river must be well designed, not just “pretty”, to prevent trail braiding and damage to the riparian area.

”
Survey Respondent

Safety of Trails

Comments provided when answering survey question “Do you have anything else to add regarding the draft Meadow park Master Plan, spray park and playground concepts?”

“

I strongly agree that the valley trail should be relocated and not run between the spray park and playground. Kids will go back and forward and not having to worry about bikes ripping by is a great benefit!

Survey Respondent

”

“

Do not allow bikes on the path between the playground and spray park. We live in Alpine with two kids and know that children will run between the two. Limit the chance of collisions with bikers/users and children crossing.

Survey Respondent

”

“

Do not put a valley trail or walking path between the spray park and the playground. Open up things and connect them together. Connecting visually and for the user, that means not cutting through the area with path and trail. Kids are going to play in the bioswale, need more swings at the playground.

Survey Respondent

”

Next Steps

Currently, the RMOW (Resort Municipality of Whistler) only has funding for Phase 1, which includes the splash park and playground. The design consultant and municipal staff will carefully review and consolidate survey responses, integrating them where feasible into the Phase 1 design and the draft master plan. As of now, the second phase of the project lacks funding, and RMOW will undergo several steps to refine the design once funding becomes available.

The graphic below illustrates that community input is just one of many factors influencing the development of the Meadow Park Draft Master Plan. Feedback from respondents, in conjunction with best design practices, amenities present in the neighborhood, and existing policy guidelines for neighborhood-level parks, will shape the final design of the new park.

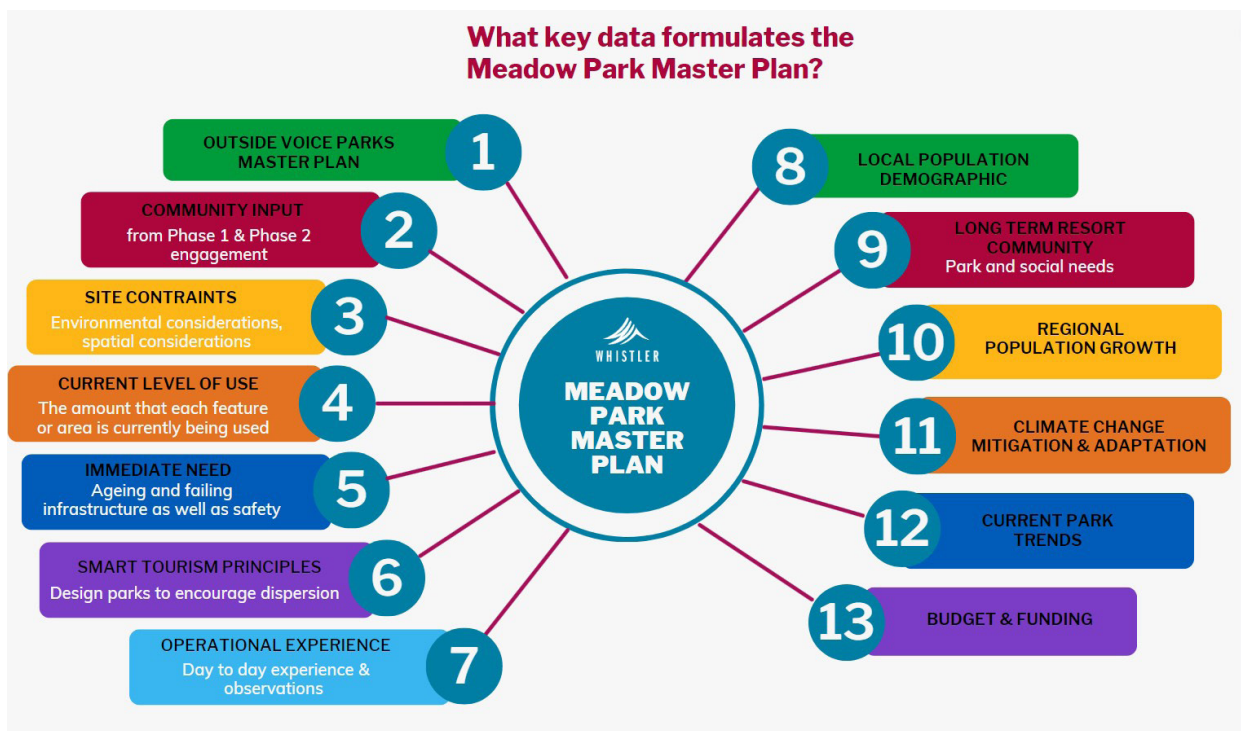



Please Note:

While a variety of tactics were used to reach a diverse range of citizens, results from open surveys such as those provided do not represent a statistically significant, random sample of all Whistler and surrounding area residents. Due to the opt-in and open nature of participation, results do not necessarily reflect the views of all Whistler residents.

Additional efforts were made to connect with harder-to-reach communities via affected parties and community liaison networks; however, under-represented groups and individuals remain under-represented in the overall results.

Additionally, results may not be representative of groups experiencing housing need, including those experiencing homelessness or accessing housing with supports.



Appendix

Open House Boards

INTRODUCTION



Meadow Park RePLAY Phase 2

Overview



- Meadow Park was constructed almost 40 years ago.
- Requires reinvestment for climate change resilience, improving public safety, and addressing aging infrastructure.
- It serves as a destination park and community amenity hub.
- Whistler parks visitation has rapidly increased, with over 176,000 visits to four destination parks in summer 2021 (Lost Lake Park, Rainbow Park, Lakeside Park and Alpha Lake Park).
- This project aims to enhance the user experience of Meadow Park by improving the comfort level and upgrading the existing infrastructure.

Design Considerations



- The design for Meadow Park will be implemented in phases, with the initial phase focusing on revitalizing the spray park and playground.
- The Meadow Park **master plan** includes several key features, such as expansive areas of open space, a dedicated enclosed area for off-leash dogs, direct access to the River of Golden Dreams, and the renovation of the playground and spray park facilities.
- The proposed **spray park** includes different elements like a water slide, ground sprays, and other features. It also acknowledges the nearby natural features and integrates the concept of water conservation.
- The proposed **playground** has numerous opportunities for climbing and swinging, along with a sizable zipline, all situated on a resilient rubber play surface and wood fibre, ensuring accessibility and enhancing safety in comparison to the current playground.

Timeline

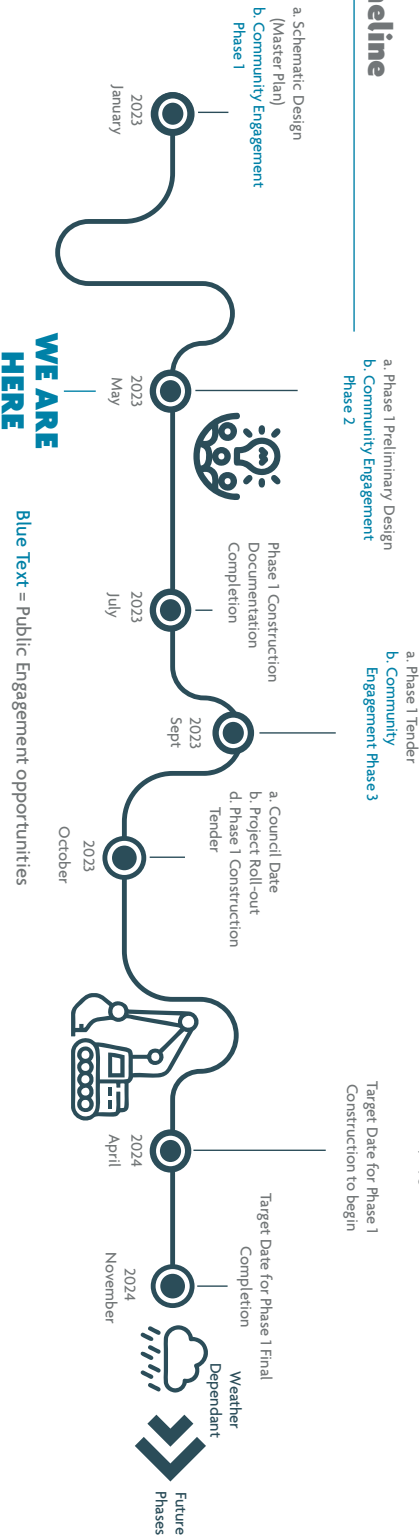

ENGAGEMENT SUMMARY



Meadow Park RePLAY Phase 2:

What Key data Formulates the Meadow Park Master Plan?

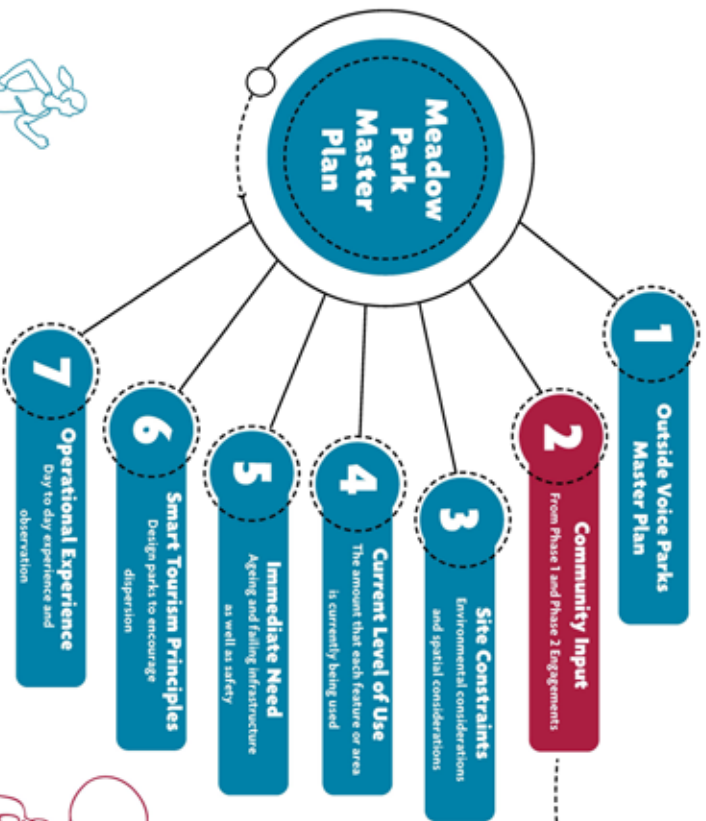

What we Heard

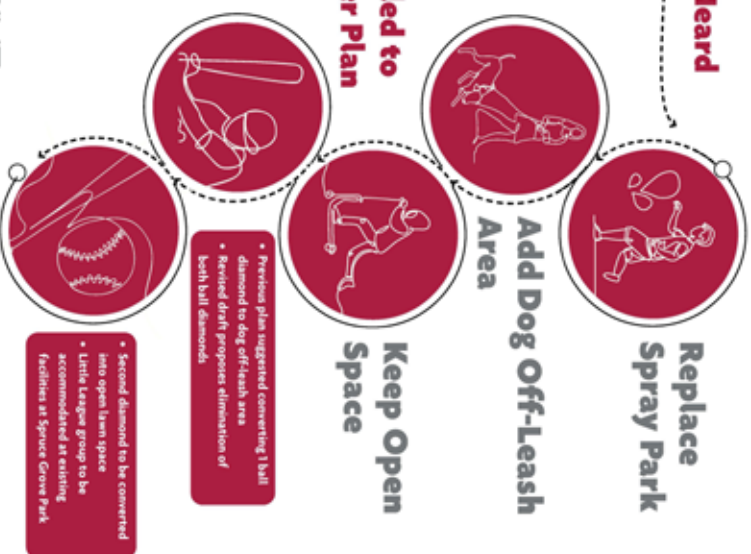

Engagement Summary

Appendix

Open House Boards

MASTER PLAN

To help explain the Meadow Park RePLAY master plan, a set of illustrations called 'vignettes' have been created. These vignettes showcase numerous essential features of the proposed master plan.



Appendix

Open House Boards

SPRAY PARK



Perspective Looking North at the Spray Park



Labelled Plan of Proposed Splash Park

This panel provides a detailed view of the proposed spray park, highlighting its features and the various activities that visitors can enjoy. The park is designed to include a range of water-based features labelled below.

To help visitors better understand the water usage associated with each activity, the bottom of the panel features icons that indicate the amount of water that each activity is expected to use.

Proposed Spray Park features include:

- 1 Bucket Dump
- 2 Water Slide
- 3 Water Channel
- 4 Water Sprays
- 5 Sand and Water Play
- 6 Bioswale

Less Water
More Water

Sand Play

Fog/Mist

Tunnel

Ground Spray

Cannons

Soak

Interactive Fountain

PLAYGROUND

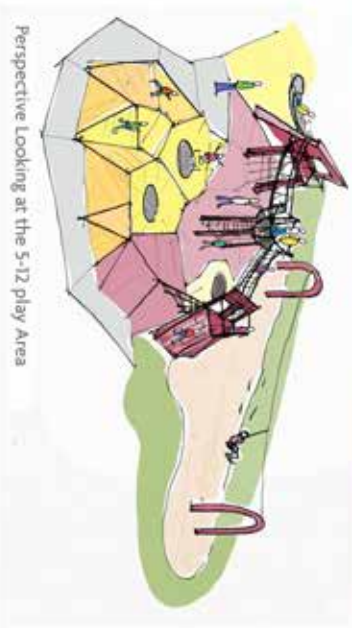

Perspective Looking at the 5-12 play Area



Labelled Plan of Proposed Playground



This panel offers a comprehensive view of the proposed playground, showcasing its various features and the wide range of activities that visitors can enjoy. The park is designed to include a variety of play features, which are prominently displayed throughout the panel.

From climbing structures and slides to swings and interactive play areas, the playground offers a fun and engaging experience for visitors of all ages.

Proposed playground features include:

- 1 Tot Area
- 2 Hill Slide
- 3 Themed Playstructure
- 4 Music Play
- 5 Zip Line
- 6 Swings



Imagination



Slide



Climb



Swing



Hill Play



Zip Line



Play Structure



Climb Rope



MASTER PLAN





| | |
|--|---|
| Playground Features  | <ul style="list-style-type: none"> 1 Tot Area 2 Hill Slide 3 Themed Play 4 Music Play 5 Zip Line 6 Swings |
| Splash Park Features  | <ul style="list-style-type: none"> 7 Bucket Dump 8 Water Slide 9 Water Channel 10 Water Sprays 11 Sand and Water Play 12 Bioswale |
| Dog Off-Leash Area Features  | <ul style="list-style-type: none"> 13 Agility Features 14 Lawn area 15 Seating area 16 Double Gate |
| Youth Zone  | <ul style="list-style-type: none"> 17 Parkour Area 18 Skate Area 19 Hang out zone |
| Amenities  | <ul style="list-style-type: none"> 20 Picnic area 21 Outdoor fitness 22 Bookable Space 23 Water Access 24 Valley Trail 25 Re-Naturalization |

1:300